

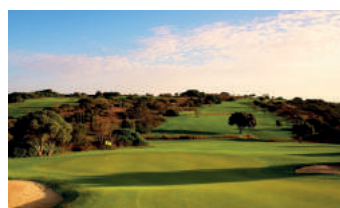

**SCORECARD**  
English



+351 282 688 250  
reservations-reception@espiche-golf.com  
Espiche • Lagos • Algarve • Portugal  
**www.espiche-golf.com**



**GECKO**  
BISTRO  
RESTAURANT-ESPICHE  
+351 282 688 270

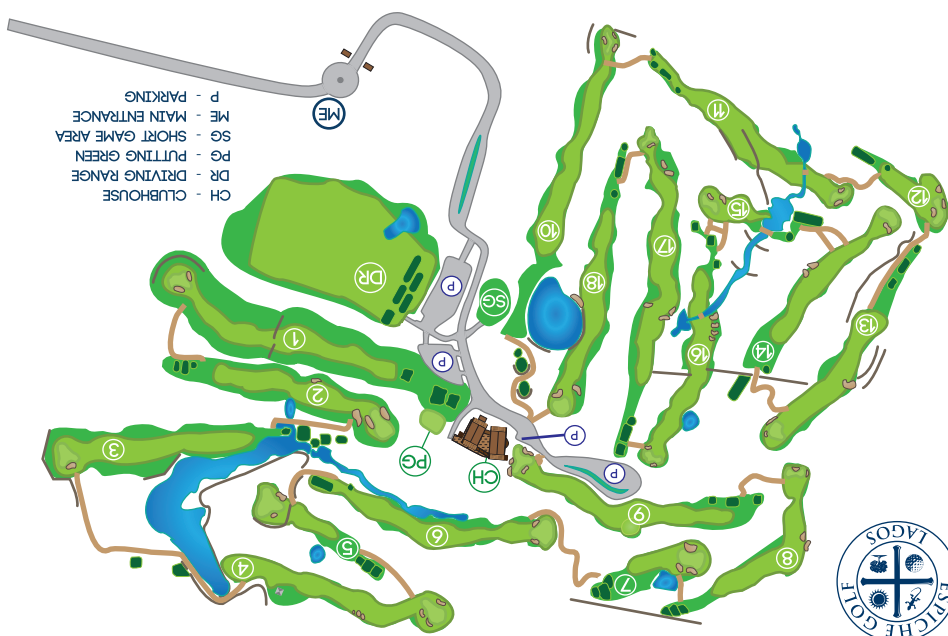

**GOLF COURSE MAP**

Competition: \_\_\_\_\_ Date: \_\_\_\_\_ Tee Time / N.º: \_\_\_\_\_

Player A	Exact H' cap		Playing H' cap		<b>Tee Used</b>	<b>Tick</b>
Player B	Exact H' cap		Playing H' cap		<b>White</b>	
Player C	Exact H' cap		Playing H' cap		<b>Yellow</b>	
Player D	Exact H' cap		Playing H' cap		<b>Red</b>	

Course Rating      72.1      70.1      73.9  
 Slope Rating      136      132      135

Players using this card for a qualifying round for handicap purposes must fill in their EGA exact and playing handicaps. Also indicate which tees played from in the spaces provides (above).

Hole	Marker	Score			Par	S.I.	Score				Nett	W=+ L=- H=0 Points
		White Metres	Yellow Metres	Red Metres			A	B	C	D		
1		444	415	383	5	9						
2		314	300	287	4	15						
3		401	387	372	4	1						
4		451	393	382	5	5						
5		184	159	144	3	17						
6		350	334	309	4	7						
7		149	131	118	3	11						
8		318	296	275	4	13						
9		356	326	292	4	3						
OUT		2967	2741	2562	36							

**Please repair pitchmarks, replace divots and avoid slow play at all times**

10		485	449	426	5	10						
11		338	305	278	4	2						
12		144	134	124	3	18						
13		336	314	278	4	6						
14		338	328	283	4	12						
15		151	129	111	3	14						
16		332	326	297	4	8						
17		430	404	390	5	16						
18		341	323	277	4	4						
IN		2895	2712	2464	36							
OUT		2967	2741	2562	36							
TOTAL		5862	5453	5026	72							

Player's Signature	Gross	Handicap	Nett	Stableford Score points
Marker's Signature				

## Local Rules

The rules of the Royal & Ancient Golf Club of St. Andrews and the following local rules govern all play:

1. Stones in bunkers, "Stones in bunkers are movable obstructions (Rule 24-1 applies)";
2. Immovable obstructions Rule (24-2) Relief may be taken from; (a) water irrigation equipment (all sprinkler heads and control satellites) (b) buggy paths and service roads (c) stone constructions outside a hazard, including retaining walls and boundary walls (d) young trees which have been tagged or staked with blue coloring;
3. Out of bounds ( Rule 27 applies) (a) beyond boundary fences (b) beyond white posts outlining out of bounds (c) in the car park to the right of the 9th hole;
4. Course conditions (a) embedded balls (b) need to clean ball, lift clean and wipe (c) preferred lies/winter rules (d) aeration holes. Relief will be available at certain times of the year and notice will be given at Reception and on the member's notice board;
5. Greenkeepers work is considered ground under repair. Relief without penalty may be taken in accordance with Rule 25;

### Etiquette

1. No player may start a round without registering at Reception;
2. Golf shoes with soft spikes must be worn. The Starter will check this;
3. The Club dress code must be adhered to. The Starter will not allow players to commence play if any part of the code is ignored;
4. If any group loses more than one hole on the group in front they must call the following group through. Failure to do so in competitions will incur penalties;
5. The Marshalls may instruct players to quicken their pace of play or allow a group through; any requests ignored may result in the players being asked to leave the course.

**100, 150 and 200 metre distance markers are measured to the centre of green.**

WHITE POSTS  
Out of Bounds

YELLOW POSTS  
Water Hazards

RED POSTS  
Lateral Water Hazards

BLUE POSTS  
Ground Under Repair